

Instructions for use of Zimi mask

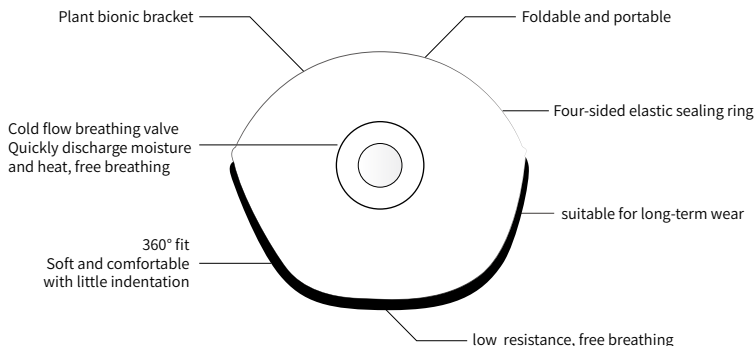

Mask protection level classification

protection category load filtration efficiency	non-oily particle protection	non-oily particle and oily particle protection
≥90.0%	KN90	KP90
≥95.0%	KN95	KP95
≥99.97%	KN100	KP100

Performance Table

MODEL	9541 Earloop	9541 Valve earloop	9541 Headloop	9541 Valve headloop
Standard	GB2626-2019 KN95			
Size	M			
Specification	Earloop	Earloop	Headloop	Headloop
Loading filtration efficiency*	98%	98%	98%	98%
Initial filtration efficiency	99.5%	99.5%	99.5%	99.5%
Inhalation resistance	55Pa	65Pa	55Pa	65Pa
leakage	2%			
Valve	NO	YES	NO	YES
Shelf life	3 Years			
Filter Elements	YES			

Performance Table

MODEL	7711 Earloop	7711 Valve earloop	7711 Headloop	7711 Valve headloop
Standard	GB2626-2019 KN95			
Size	S			
Specification	Earloop	Earloop	Headloop	Headloop
Loading filtration efficiency*	98%	98%	98%	98%
Initial filtration efficiency	99.5%	99.5%	99.5%	99.5%
Inhalation resistance	60Pa	70Pa	60Pa	70Pa
leakage	1.6%			
Valve	NO	YES	NO	YES
Shelf life	3 Years			
Filter Elements	YES			

Performance Table

MODEL	8210 Headloop	8210 Valve headloop	95S Headloop	95S Earloop
Standard	GB2626-2019 KN95			
Size	L		XXS	
Specification	Headloop	Headloop	Headloop	Earloop
Loading filtration efficiency*	99%	99%	98%	98%
Initial filtration efficiency	99.5%	99.5%	/	/
Inhalation resistance	50Pa	60Pa	100Pa	100Pa
leakage	1.8%	1.8%	1.9%	1.9%
Valve	NO	YES	NO	NO
Shelf life	3 Years			
Filter Elements	YES			

Performance Table

MODEL	9233 Headloop	ZM100 Headloop	95W Earloop
Standard	GB2626-2019 KN100		GB/T38880-2020 W
Size	M	L	XXS
Specification	Headloop	Headloop	Earloop
Loading filtration efficiency*	99.97%	99.97%	/
Initial filtration efficiency	99.99%	99.99%	99%
Bacterial Filtration Efficiency	/	/	99%
Inhalation resistance	120Pa	110Pa	16Pa*
leakage	1.9%	1.7%	/
Valve	NO		
Shelf life	3 Years		
Filter Elements	YES		

Performance Table

ONE	MODEL	ONE Headloop	ONE Earloop
	Standard	GB2626-2019 KN95	
	Size	M	
	Specification	Earloop	Headloop
	Loading filtration efficiency*	98%	
	Initial filtration efficiency	99.9%	
	Inhalation resistance	40Pa	
	leakage	0.8%	0.3%
	Valve	NO	
	Shelf life	2 Years	
Filter Elements	YES		

*The above [initial filtration efficiency] is based on the GB19083-2010 "Medical Protective Mask" filtration efficiency pretreatment test results announcement

*GB/T 38880-2020 W test flow rate is 30L/min, GB2626-2019 test flow rate is 85L/min;

The loading filtration efficiency in the above table is tested according to the GB2626-2019 standard, the loading filtration efficiency is displayed according to the minimum value, and the leakage test is displayed according to the maximum value;

*/ means that this project has not been sent for third-party testing, which does not mean that it cannot pass.

【Headloop】How to Wear

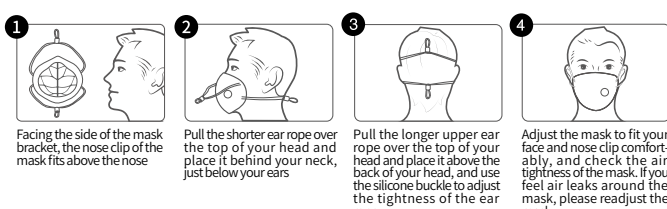

【Earloop】How to Wear

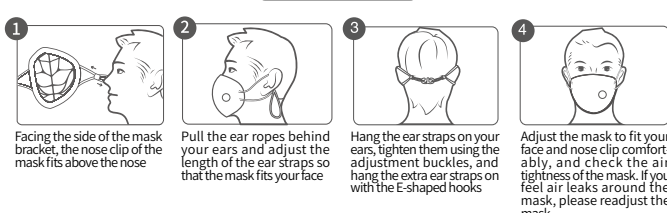

【Neck wear】How to Wear

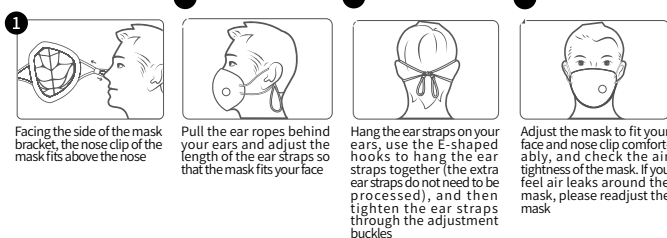

【Filter Elements】Assembly Method

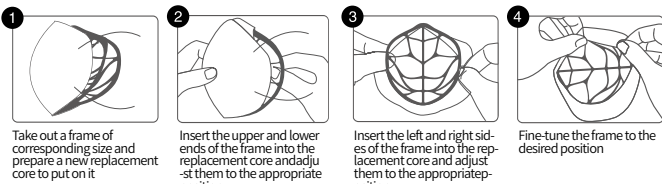

Headloop model wearing video



Earloop wearing video



Neck wear video



Filter assembly video

Please read the reverse side carefully

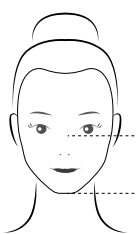

Distance from nose to chin (mm)

Mask size selection recommendations

95mm	XXS	ZM95W/ZM95S
110mm	XS	
115mm	S	ZM7711
115mm	M	ZM9541/ZM9233/ONE
120mm	L	ZM8210/ZM100
120mm	XL	

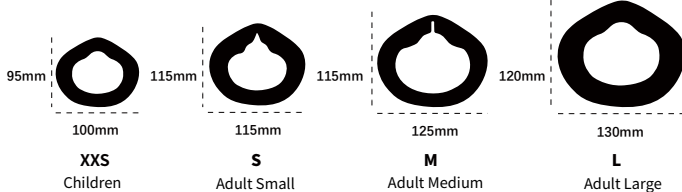

Mask fit test method

Quantitative fit test (QNFT), professional test, using test instruments such as Portacout, can accurately determine whether the mask is suitable, without subjective influence.

Qualitative fit test (QLFT), sweeteners or bittering agents are used as test reagents. The taste perception can roughly determine whether the mask is suitable. The subjective feeling is more suitable for people who are sensitive to taste. Use the atomizer to wear a head cover and breathe through the mouth. Dilute the atomizer bottle with pure water and sodium saccharin (easy to clog the nozzle) or bittering agent (denatonium benzoate), spray it into the head cover. Tasting the taste means that the fit test has failed and the experiment is stopped. The specific operation process and test methods can be found on the Internet.

Instructions for use

1. Please read this instruction manual before use, fully understand the content, and keep the manual properly. If you find anything unclear during use, please confirm the content at any time;
2. Failure to use this mask in accordance with the instructions and usage restrictions will reduce the protective effect of the mask and may cause illness or even death;
3. Particles that are harmful to health include tiny substances that are invisible to the naked eye;
4. If you feel dizzy, irritated or otherwise uncomfortable during use, you should leave the contaminated area immediately;
5. When not in use, the mask should be stored in a non-polluting environment;
6. Before each use, check the mask to ensure that it is in good working condition, check all parts of the mask, including the headband rope, connection points for signs of damage, and the integrity of the mask exhaust valve structure. If any parts are found to be damaged or missing, the mask should be discarded immediately;
7. Please discard used masks in accordance with applicable regulations;
8. Particulate protection masks cannot absorb odors and gases. It is normal to smell odors when wearing protective masks. If you need to protect against odor or harmful gases, please choose a mask containing activated carbon adsorption material;
9. Some models of products have separate filter elements for sale. The filter element cannot be used alone. It must be matched with a corresponding size bracket to ensure that the fit (leakage) meets the standard requirements;
10. The product design is not flame retardant. This product is not suitable for use in workplaces with open flames (such as welding, casting, etc.).

Usage restrictions and warnings

1. KN95 and KN100 grade masks can be used for respiratory protection against non-oily particles, and KP95/KP100 grade masks can be used for respiratory protection against oily and non-oily particles (non-oily particles such as dust, smoke, microorganisms and non-volatile mist, etc. Oily particles such as oil smoke, oil mist, asphalt smoke, coke oven smoke, and particles in automobile exhaust, etc.);
2. It is strictly forbidden to use in an oxygen-deficient environment (oxygen concentration is less than 19.5%), an unknown oxygen concentration, or a toxic gas environment. Otherwise, it may lead to death or acute symptoms due to hypoxia symptoms, gas poisoning, etc.; ZM8577 and ZM8576 masks containing activated carbon particles are odor absorption and removal masks, which can remove organic vapor or acidic gas within a certain period of time. Please confirm the gas composition in the environment before use;
3. It cannot be used in an environment where harmful substances are unknown or the concentration reaches a threat to life and health;
4. Do not use this product when facial beard, hair or other conditions affect the airtightness between the face and the mask;
5. Do not change, wash, abuse or use this mask incorrectly;
6. When breathing difficulties, dizziness and other discomfort occur, leave the contaminated area immediately and seek medical attention if necessary;
7. When the mask is damaged or the breathing resistance increases, replace it with a new mask immediately;
8. Failure to wear the mask in accordance with the instructions, restrictions and warnings during use, and failure to wear the mask throughout the process of exposure to pollutants will reduce the effectiveness of the mask protection, which may cause disease or permanent damage to the body;
9. Masks can provide respiratory protection against certain air pollutants, but they cannot prevent pollutants from entering the human body through other routes, such as skin, etc. Additional personal protective equipment (PPE) is required for protection;
10. This mask is designed as an occupational (professional) protective equipment. The user should be an adult who has received appropriate training on how to use it and understands the restrictions on its use;
11. Children should wear masks under the care or guidance of adults. This product is not suitable for infants and young children aged 3 years and below and children with respiratory defects. Children should not perform moderate or higher intensity exercise and avoid fighting while wearing and using the mask;
12. People with certain respiratory diseases, such as asthma or emphysema, should consult a physician before using a protective mask and complete a medical evaluation;
13. It is strictly forbidden to use 95-level masks in areas where radioactive material leakage may cause contamination, asbestos dismantling workshops, and may be exposed to dioxin environments. For such environments, please choose KN100 or KP100 grade masks.

Storage conditions and shelf life

Before use, place this product in its original packaging in a dark environment, away from polluted areas, and avoid dust exposure, extreme temperatures, excessive moisture, and harmful chemicals. When the storage temperature and humidity conditions meet the requirements of -20°C~+45°C and relative humidity ≤ 80%, this product can be used before the "storage period" date specified on the packaging.

Wear a mask to check air tightness

Perform an airtightness test every time you wear a mask. If you wear it incorrectly, particles will leak from the gap between the face and the mask into the mask cavity and be inhaled.

Do not hold the exhaust valve cover or the area around the exhaust valve cover. When the exhaust valve cover and the exhaust valve base deviate from the main body of the mask, particles will enter the mask and be inhaled by the user.

Method 1 For protective masks without valves - exhale quickly, for protective masks with valves - inhale quickly

Every time you wear a mask, you should check the air tightness of the user. The sealing ring of the bracket mask is made of airtight material. Through the rapid breathing/inhalation process, it is found that there is obvious air leakage at the nose clip position of the mask and around the face.

1. Please tighten the mask ear straps. For ear-hook masks, please use hooks to tighten the ear straps. You can tighten the upper ear rope again to increase the tightness of the nose bridge.
2. Move the mask up and down along the nose bridge to find a suitable position without air leakage.
3. You can stick a sponge strip on the nose clip inside the mask bracket to solve the problem. A small number of people need to use flat sponge strips or wavy sponge strips to adjust the fit of the mask.
4. If you cannot get a good fit, please choose a mask of other models or categories.

Method 2 Lighting method

Use light to illuminate different positions on the surface of the mask and observe whether there is light leakage at the edge where the mask fits the face. This can be used to preliminarily determine whether the mask is suitable (it is not recommended to use this method of tightness inspection for masks with large ultrasonic indentations or welding point processes on the surface of the mask)

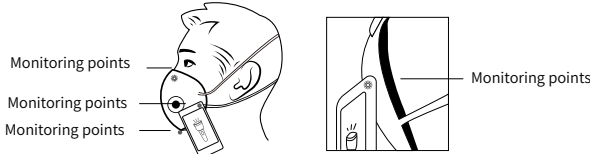

Method 3 Scrap/Flour

After wearing the mask, place scraps of paper (tissue paper) or edible flour above the nose clip and around the mask and face. Inhale or exhale to observe whether the scraps of paper or flour move or change significantly. If there is a significant change, tighten the mask ear straps and adjust the mask position and repeat the above inspection steps. This method is suitable for more people to test the tightness of the mask at home.

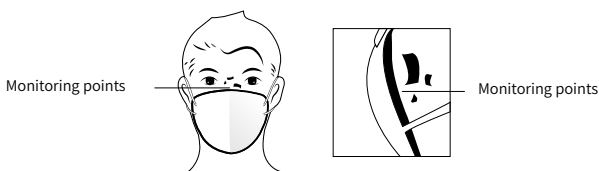

Sponge bar usage suggestions

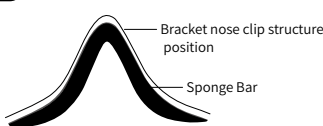

Sponge Strip Usage Video

Due to differences in human facial structure, the provided sponge strip will be attached to the nose clip inside the bracket (a small number of people need to use a flat sponge strip or a wavy sponge strip). The sponge strip can improve the air tightness of the nose clip of the mask and increase wearing comfort.

Precautions

1. This product is a cumulative disposable mask. Please discard it after the recommended duration (15 hours for industrial use/30 hours for civilian use). If it shrinks, breaks, or is significantly deformed during the recommended duration, affecting the close fit of the mask, or if it becomes clogged with particles and causes breathing difficulties, please replace the mask in time (*Due to differences in each person's wearing environment, purpose of use, or post-wearing processing and storage methods, the recommended duration is not a promised usage duration. In high-risk environments, it is recommended to reasonably and safely increase the number of mask replacements based on usage);
2. If the use of the mask causes allergic symptoms such as rough facial skin and eczema, please stop using it and follow the doctor's advice;
3. Please keep the mask clean at all times. If the face and ear straps are soiled, it may cause contact dermatitis;
4. Please wear the mask in a safe environment without harmful substances;
5. When storing the mask, avoid substances that may contaminate the mask from entering the inside of the mask to prevent it from being inhaled while wearing;
6. When using the mask, please keep track of how long it has been used;
7. When discarding the used mask, please put the mask in a bag and seal it to prevent the dust attached to the mask from flying again;
8. Do not wear the mask after covering your face with other items, which may cause particles to leak into the mask.

Other content

The following actions are strictly prohibited, otherwise the mask will be deformed, damaged and its performance will be degraded;

- 1) Flick off the dust attached to the surface of the mask;
- 2) Use air from an air compressor to blow off the dust attached to the mask, or use a vacuum cleaner to remove the dust on the mask;
- 3) It is strictly prohibited to wash the mask with water;
- 4) Grasp the outer cover of the exhaust valve or the area around the outer cover of the exhaust valve to adjust the wearing position.



This protective mask is only used for respiratory protection against certain particles. Improper use can lead to illness or even death. Due to differences in individual face shapes, this product cannot guarantee the suitability of all wearers. A suitability test is required before use. The fit of the mask is directly related to the protective effect of the wearer during actual use. Due to differences in individual face shapes, efforts in the design of protective mask products can only improve its applicability among different individuals, that is, it can achieve better facial fit in a larger proportion of the population, but it cannot be suitable for all wearers.

Mask knowledge focus [Zhou Liang's mask]



@zhouliang_mask

Manufacturer: Shanghai Zhimi Air Purification Technology Co., Ltd.
Address: Room 201, Building 1, No. 166, Miyi Road, Sijing Town, Songjiang District, Shanghai